

ITEM NO.	QTY	PART NUMBER	DESCRIPTION	LENGTH	ITEM NO.	QTY	PART NUMBER	DESCRIPTION	LENGTH	ITEM NO.	QTY	PART NUMBER	DESCRIPTION	LENGTH
47	1		BREATHER 3/8" BSPT		26	2	W45-0642	W45 DRAG BRAKE PAD SPRING -INNER	0.725	1	1	W45-0101	WORMBOX HOUSING	
48	1		GREASE NIPPLE 1/8" BSP		27	2	W45-0641	W45 DRAG BRAKE PAD SPRING - OUTER	0.725	2	2	W45-0700	BUSH - WORMBOX COVER	69.9
49	4		HEX HEAD BOLT 1/2"-13 UNC x 2"		28	2	W45-0640	DRAG BRAKE PAD	27.9	3	1	W45-0520	WINCH SHAFT - STANDARD	808
50	8	HHSS 0.625-18x1.75	HEX HEAD BOLT 5/8"-18 UNF x 1 3/4"		29	2		KEY - IMPERIAL	3/4" SQ x 4 1/2"	4	2		KEY - IMPERIAL	3/4" SQ x 2 7/8"
51	6	HHSS 0.500-13x1.5x1.25	HEX HEAD SET SCREW 1/2"-13 UNC x 1 1/2"		30	1	W45-0620	W45 DOG CLUTCH	Ø188 x 88.9	5	1	W45-0440	WORMWHEEL HUB	76.7
52	6		SOCKET HEAD CAP SCREW 1/2"-13 UNC x 1 1/2"		31	8		SPRING WASHER 5/8"		6	1	W45-0420	WORMWHEEL	Ø295.3 x 85.7
					32	8	HHSS 0.3125-18x0.75	HEX HEAD BOLT 5/8"-11 UNC x 2"		7	1	W45-0151	WORMBOX COVER	
					33	1		3/8" BEARING BALL		8	1	W45-0802	WORMBOX COVER GASKET	Ø354
					34	1	W45-0631	DOG CLUTCH DETENT SPRING	0.23	9	8	HHSS 0.3125-18x0.75	HEX HEAD SET SCREW 1/2"-13 UNC x 1 1/4"	
					35	1		SOCKET SET SCREW 1/2"-13 UNC x 1/2"		10	1	W45-0402	WORM - HYDRAULIC	
					36	1	W45-0251	CLUTCH HOUSING		11	1		KEY - IMPERIAL	1/2" SQ x 2 1/4"
					37	1	W45-0702	BUSH - DOG CLUTCH HOUSING	82.6	12	4		ANGULAR CONTACT BALL BEARING 7310-B 50°110°27	
					38	1	W45-0271	W45 DOG CLUTCH HANDLE		13	2	W30-0800	WORM SHAFT CAP GASKET	Ø165
					39	1	W45-0270	W45 DOG CLUTCH FORK		14	1	W30-0200	WORMSHAFT CAP	
					40	2		CAM FOLLOWER, 1 In. Dia., 5/8 In. WIDE, 7/16-20 THREADS, SEALED, MCGILL, CF-1-SB		15	1	W45-0330	HYDRAULIC MOTOR ADAPTOR	181.8
					41	1	W45-0280	CLUTCH HOUSING COVER PLATE	157.2 x 114.3	16	1	W45-0340	HYDRAULIC COUPLING	82.6
					42	4		HEX HEAD SET SCREW 3/8"-16 UNC x 3/4"		17	1	OMT 315 FH	SAUER DANFOSS HYDRAULIC BRAKE MOTOR	
					43	2		SPRING WASHER 7/16"		18	1	W45-0500	W45 STD WINCH DRUM	
					44	2	HNUT 0.3125-18-D-C-S	HEX NUT 7/16-20 UNF		19	1	W45-0610	W45 DOG CLUTCH DRUM RING	Ø266.7 x 34.9
					45	2		SPRING PIN 3/8" x 2"		20	2	W45-0701	DRUM BUSH	57.2
					46	2		PLUG - HEX SOCKET	3/8" BSPT	21	1	W45-0703	DRUM THRUST WASHER	6.4
										22	1	W45-0590	DRUM SPACER RING	15.9
										23	1	CR47481	OIL SEAL	4.75x6x0.5
										24	1		SOCKET SET SCREW 5/8"-11 UNC x 5/8"	
										25	3		GREASE NIPPLE 1/4" UNC STRAIGHT	

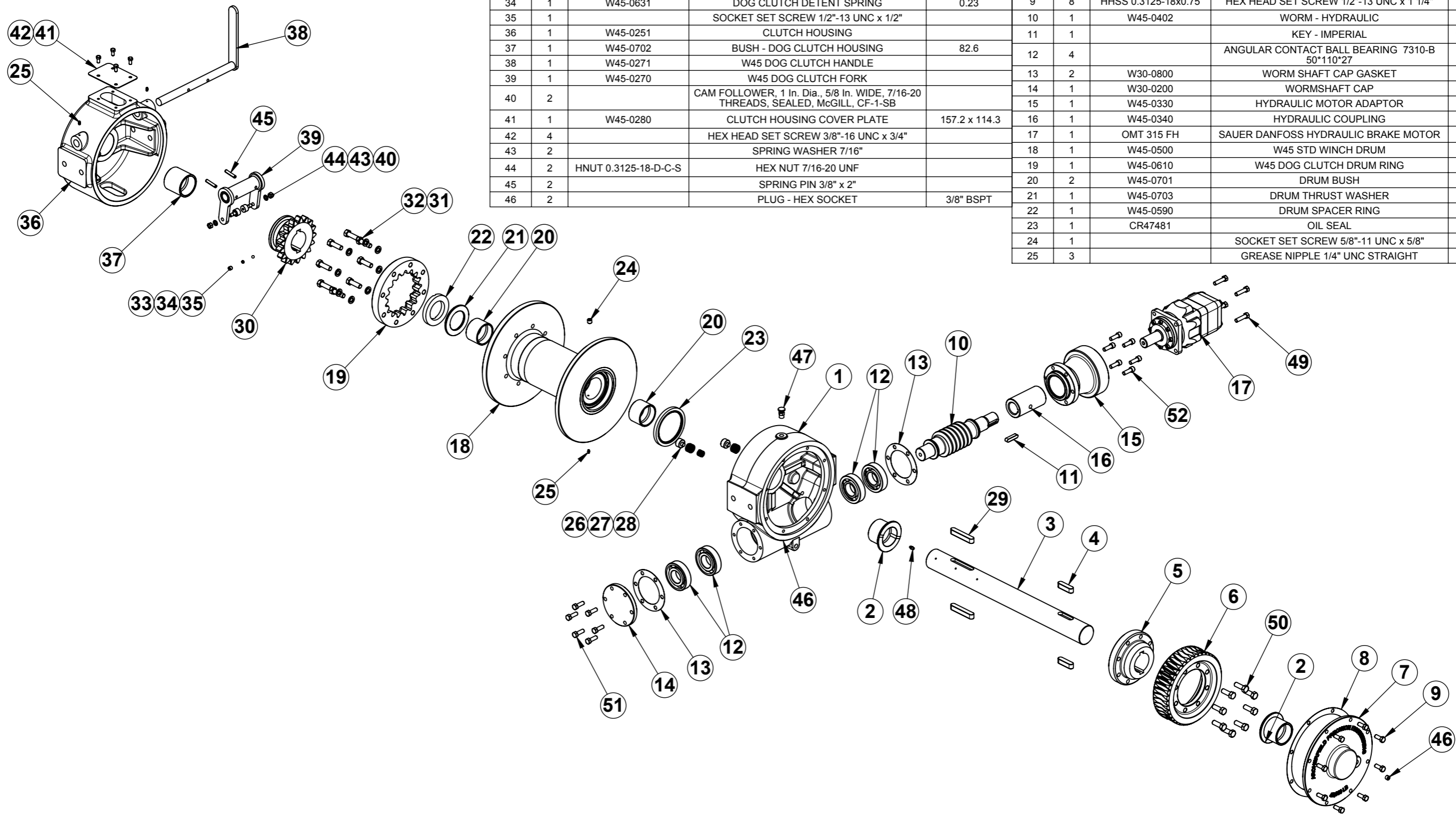

GEARS AND WINCHES
 2 COIN ST MOOROOKA QLD 4105
 PO BOX 206 ACACIA RIDGE QLD 4110
 Ph (07) 3875 1568
 Fx (07) 3277 4316
 Email admin@winch.com.au

DRAWN	RCT	01/02/13
CHECKED		
MATERIAL		
MATERIAL NOTES		
FINISH		
DATE PRINTED	WEIGHT	SCALE
01/02/13	375.7 Kg	1:15

**W45 LOW MOUNT HYDRAULIC WINCH
 STANDARD DRUM
 WITH BRAKE MOTOR
 FOR INFORMATION**

SCALE: 1:15
 SHEET No. 1 OF 1
 DWG No. W45-0023-0

DWG No	REFERENCES	REV	DATE	DESCRIPTION	DRAWN	CHECK	APPD							
1	2	3	4	5	6	7	8	9	10	11	12			

COPYRIGHT RESERVED. The design detailed on this drawing is the property of Archerfield Precision Engineering and must be returned on demand. It is issued on the strict condition that excepted to any third party, nor is it to be used for any purpose other than for which it was issued.