

ITEM NO.	QTY	PART NUMBER	DESCRIPTION	LENGTH	WEIGHT	ITEM NO.	QTY	PART NUMBER	DESCRIPTION	LENGTH	WEIGHT
33	1	W20-0500	DRUM ASSEMBLY		36.5	1	1	W20-0101	W20 WORMBOX HOUSING		9.7
34	1	W20-0702	DRUM BUSH - DOG CLUTCH END	41.3	1	2	2	W20-0700	BUSH - WORMBOX	41.3	1
35	1	W20-0701	DRUM BUSH - WORMBOX END	44.5	0	3	1	W20-0550	W20 DRUM SHAFT - STANDARD	673.1	16.5
36	1	W20-0590	DRUM SPACER RING	15.9	0.4	4	2		KEY - IMPERIAL	5/8" SQ x 2 3/16"	0.1
37	1	W20-0251	W20 DOG CLUTCH HOUSING		10.0	5	1		KEY - IMPERIAL	5/16" SQ x 1 1/8"	0.0
38	1	W20-0703	BUSH - DOG CLUTCH HOUSING	63.5	1	6	1		KEY - IMPERIAL	1/4" SQ x 1 1/2"	0.0
39	1	W20-0610	DOG CLUTCH	73	4	7	2		KEY - IMPERIAL	5/8" SQ x 2 7/8"	0.1
40	1	W8-0631	DOG CLUTCH DETENT SPRING	0.55		8	1	W20-0440	WORMWHEEL HUB	57.2	5
41	1		SOCKET SET SCREW 1/2"-20 UNF x 1/2"			9	1	W20-0420	W20 WORMWHEEL - 41T	57.2	6.5
42	1		SOCKET SET SCREW 5/8"-11 UNC x 5/8"			10	1	W20-0802	WORMBOX COVER GASKET	Ø292.1	0.02
43	1	W20-0270	W20 W16 DOG CLUTCH YOKE		0.8	11	1	W20-0151	W20 WORM BOX COVER		2.8
44	1	W20-0271	W20 W30 DOG CLUTCH HANDLE	457	2	12	1	W20-0403	W20 WORM - HYD WITH WORMBRAKE	375.3	5.0
45	2		SPRING PIN 5/16" x 1 1/2"			13	2		ANGULAR CONTACT BALL BEARING 7307-B	35*80*21	
46	2		PLUG - HEX SOCKET	3/8" BSPT		14	2	W20-0800	WORM SHAFT CAP GASKET	Ø120.7	0.01
47	1		BREATHER 3/8" BSPT			15	1	CR24898	OIL SEAL	2.5x3.25x0.375	*0.09
48	1		GREASE NIPPLE 1/8" BSP			16	1	W20-0202	WORMBRAKE HOUSING		2.5
49	2		GREASE NIPPLE 1/4" UNC STRAIGHT			17	1	W20-0750	WORMBRAKE HUB	Ø109.5 x 47.6	0.9
50	1	HNUT 0.3125-18-D-C-S	HEX NUT 1/2"-20 UNF			18	2		1/2" BEARING BALL		
51	1	HHSS 0.3125-18x0.75	HEX HEAD SET SCREW 1/2"-20 UNF x 2"			19	1		3/8" BEARING BALL		
52	8		HEX HEAD SET SCREW 3/8"-16 UNC x 1"			20	1	W20-0751	WORMBRAKE CAM	Ø109.5 x 10	0.6
53	4	HHSS 0.3125-18x1	HEX HEAD SET SCREW 5/16"-18 UNC x 1"			21	1	W20-0752	WORMBRAKE FRICTION DISC	Ø109.5 x 6.4	0.1
54	2	HHSS 0.3125-18x0.75	HEX HEAD SET SCREW 3/8"-24 UNF x 2"			22	1	W20-0753	WORMBRAKE RETAINER	Ø109.5 x 10	0.6
55	6		HEX HEAD BOLT 3/8"-16 UNC x 1 1/4"			23	1	W20-0754	WORMBRAKE LEAF SPRING	93.1 x 34.9	0.1
56	10	HHSS 0.3125-18x0.75	HEX HEAD BOLT 1/2"-13 UNC x 1 1/2"			24	1	W20-0755	WORMBRAKE ANTI-RATTLE SPRING		
57	6		3/8"-16 UNC x 1 1/4" SOCKET HEAD CAP SCREW			25	1	W20-0801	WORMBRAKE CAP GASKET	Ø138.1	0.00
						26	1	W20-0203	W16 W20 W30 WORMBRAKE CAP		1.19
						27	1	W20-0330	W16 W20 HYDRAULIC MOTOR ADAPTOR		1.1
						28	1	W20-0340	W20 HYDRAULIC COUPLING	77.8	1.2
						29	1		SAM HYDRAULIC MOTOR BG S 200		
						30	2	W45-0642	W45 DRAG BRAKE PAD SPRING -INNER	0.725	
						31	2	W45-0641	W45 DRAG BRAKE PAD SPRING - OUTER	0.725	
						32	2	W45-0640	DRAG BRAKE PAD	27.9	0.03

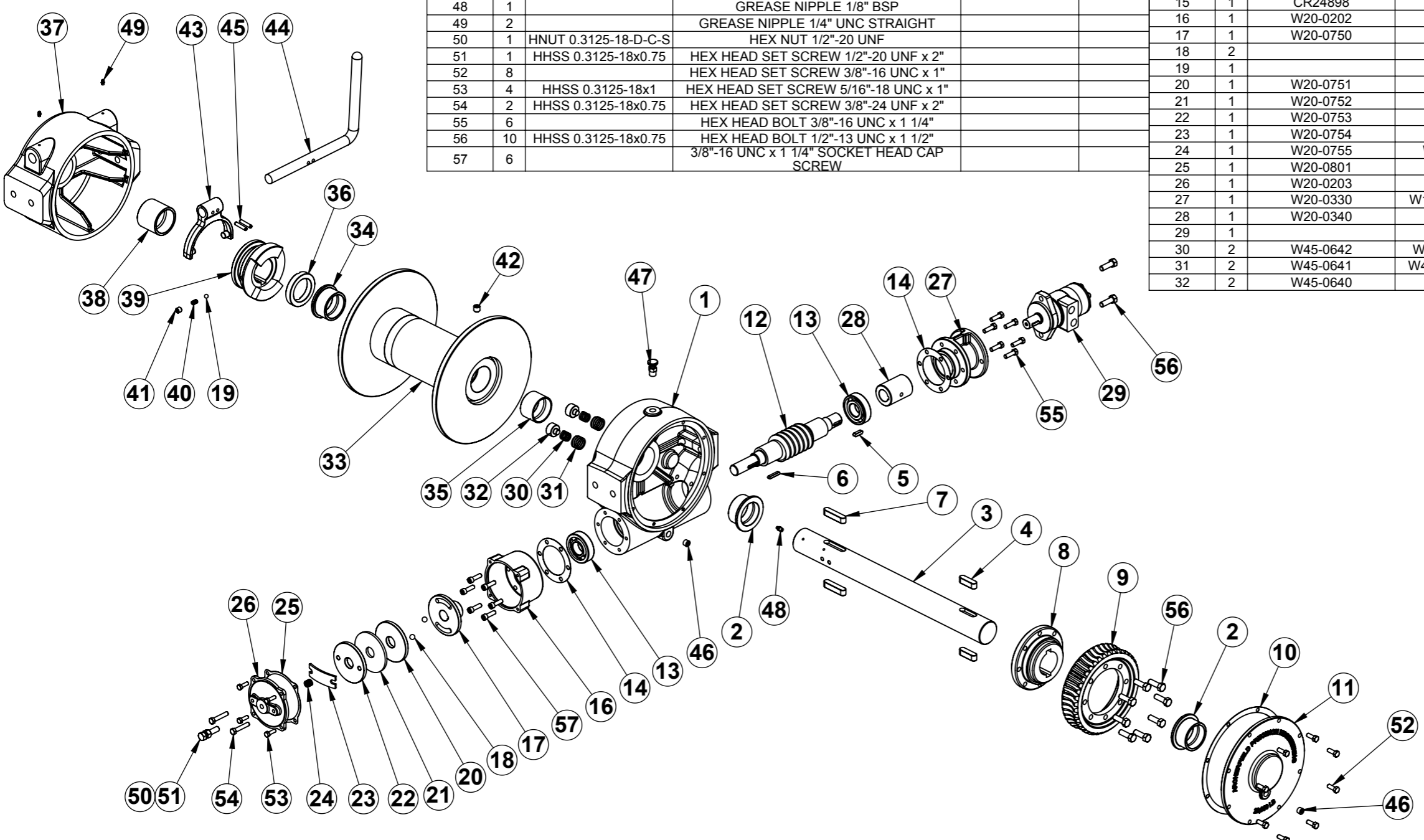

						GEARS AND WINCHES 2 COIN ST MOOROOKA QLD 4105 PO BOX 206 ACACIA RIDGE QLD 4110 Ph (07) 3875 1568 Fx (07) 3277 4316 Email admin@winch.com.au			DRAWN RCT 20-08-10 CHECKED MATERIAL MATERIAL NOTES FINISH		20,000 LB WINCH W20 LOW MOUNT HYDRAULIC WINCH STANDARD DRUM PARTS LIST FOR MANUFACTURE					
DWG No		REFERENCES		REV	DATE	DESCRIPTION		DRAWN	CHECK	APPD	DATE PRINTED	WEIGHT	SCALE	SHEET No.	DWG No	- REV
1		2		0	18/02/11	FOR MANUFACTURE					18/02/2011	120.6 Kg	1:12	1 OF 1		W20-0010-0